

# Get In the Know About **I<sup>3</sup>** BIOMETRIC PRODUCTS



**I** biometric products provide customers with solutions for identity management, access control, and time and attendance. Our modular enterprise architecture for biometric verification can be applied to both small and large installations, will identify unknown individuals, and confirm the identity of known individuals, easily controlling or monitoring access to locations and events.

## FACIAL AUTOMATED BIOMETRIC IDENTIFICATION SYSTEM (FABIS)-MOBILE

FABIS-Mobile is a scalable mobile application that enables 1: very many facial matching on Android platforms. With this application, Android phones and tablets are able to successfully match locally against millions of records without connectivity. If connectivity exists, FABIS-Mobile is able to communicate with back-end servers for matching even larger databases (up to billions of records).

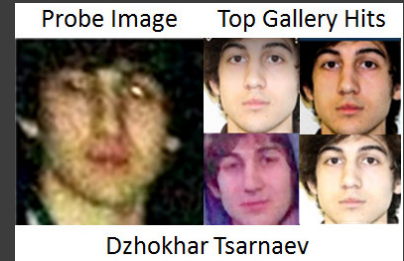

## BIOMETRIC IDENTITY VERIFIER (BIV)

The BIV is a low-cost, mobile solution for rapid biometric verification and identification, which includes a portable workstation and a FIPS201/PIV compliant fingerprint scanner certified by the FBI and included in the General Service Administration (GSA) approved products list.

## BIOMETRIC RECOGNITION AND VERIFICATION (BRAVE™)

BRaVe™ software enables users to perform biometric identification searches via their Android™ device. The BRaVe allows users to collect and perform biometric searches of an individual's face, iris, and fingerprint on a gallery of user-collected enrollments. Enrollments are stored and matched on a back-end as well as an **I** server. Barcode collection and matching is also supported.

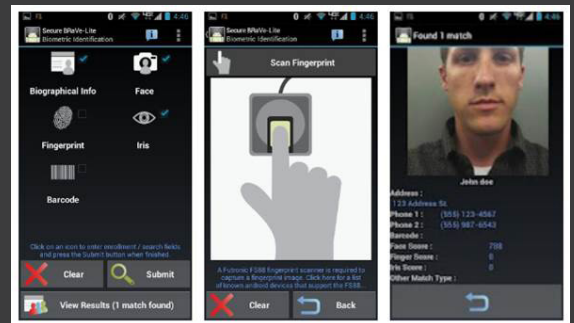

*\* Please note that fingerprint image collection requires an external iris scanner or additional (supported) software activating the on-board camera for photo-based fingerprint collection. An external iris scanner is recommended for iris support. Android devices must be capable of running in USB host mode to utilize an external fingerprint or iris scanner. Functionality is device dependent and some devices may not fully support the USB Host Mode feature.*

CONTACT US FOR MORE: [products@idealinnovations.com](mailto:products@idealinnovations.com)  
or visit us at [www.idealinnovations.com/solutions/products-menu](http://www.idealinnovations.com/solutions/products-menu)



Ideal Innovations, Inc. • 950 North Glebe Road • Suite 800  
Arlington, VA 22203 • 703-528-9101 • [www.idealinnovations.com](http://www.idealinnovations.com)

